

Building Construction Management Career Fair

September 27, 2013 | Mackey Arena

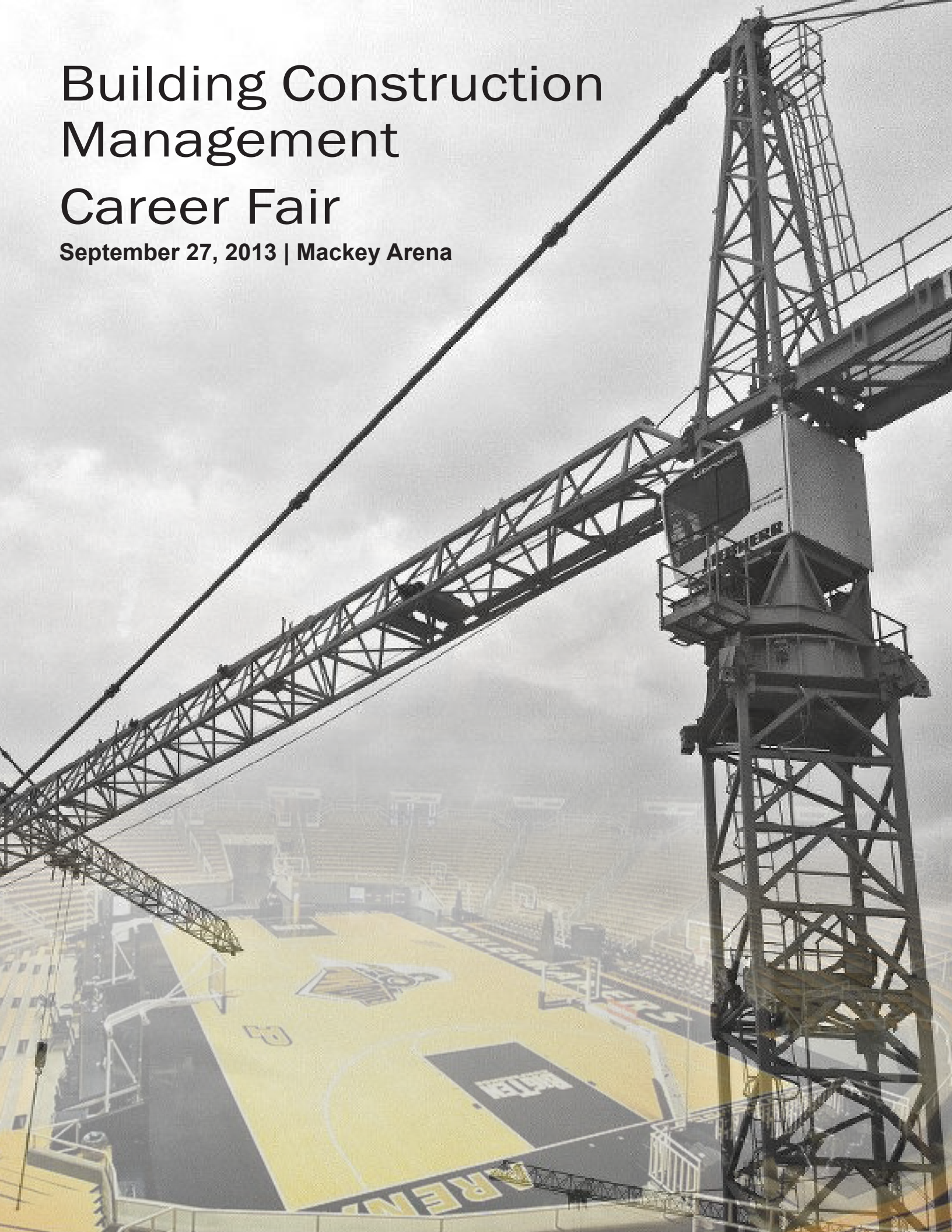

*Special thanks to
Branden S. Burke, BCM '12
for his design of the
Career Fair Guide cover.*

Fall 2013 BCM Career Fair

Company Name	Booth #	Company Name	Booth #
Aldridge Electric, Inc.	100	Kvaerner North American Construction	104
Anning-Johnson Co	64	Layne Heavy Civil, Inc.	80
ARCO/Murray National Construction	50	Ledcor Construction Inc.	12
Armstrong World Industries, Inc.	87	Lend Lease	7
Austin Commercial	93	Liberty Mutual Insurance	19
Baker Concrete Construction, Inc.	6	Marking Services, Inc.	29
Balfour Beatty Constuction	59	McCarthy Building Companies	101
Barnard Construction Company, Inc.	51	McShane Construction Company	44
Barnhart Crane & Rigging	95	Meade	40
Barton Malow Company	39	Messer Construction	4
Black & Veatch	109	Meyer Najem Construction	71
BMW Constructors, Inc.	72	Michuda Construction, Inc.	68
Bowen Engineering Corporation	67	Mortenson Construction	83
Brandenburg Industrial Service Company	113	National Demolition Association	75
CBRE, Inc.	89	Norcon, Inc.	98
CG Visions	81	NVR, Ryan Homes	49
Citgo Petroleum Company	61	Opus Design Build, LLC	46
Clayco	76	Panattoni Construction, Inc.	106
Clune Construction	107	PCL Construction	2
College Pro	31	Pepper Construction Company	10
Connelly Electric	53	Pepper Construction Company of Indiana	11
Consigli Construction Co., Inc.	21	Performance Contracting Group	102
CPM Construction	96	Performance Contractors Inc	26
CRC	38	Power Construction Company, LLC	5
Cupertino Electric	112	Power Design, Inc.	105
DPR Construction	9	ProCLAD Inc.	28
Drees Homes	41	Pulte Homes	85
Dugan & Meyers Construction	42	Purdue University Project Mgmt and Construction	110
E&B Paving, Inc.	43	Rieth-Riley Construction Co., Inc.	20
E&K Companies	58	RK Mechanical	16
Executive Construction	60	Ryan Fireprotection, Inc.	99
F.A. Wilhelm Construction Co.	62	Ryland Homes	25
F.H. Paschen, S.N. Nielsen & Assoc, LLC	17	Satterfield & Pontikes	8
FBI Buildings, Inc.	73	Saunders Construction, Inc.	92
FCI Constructors	24	Schindler Elevator Corporation	47
Finch Constructors, Inc.	111	Signature Construction, LLC	88
Firestone Building Products	91	Skanska USA	57
Frontier Industrial Corp	94	STARcon International, Inc.	69
Gaylor Inc.	66	SUFFOLK CONSTRUCTION	36
GE Johnson Construction Company	63	The Hagerman Group	37
Gilbane Building Company	35	The Hill Group	78
Harvey-Cleary	108	The Morse Group	34
Hays & Sons Complete Restoration	84	The Ross Group Construction Corporation	97
Helix Electric	79	The Skillman Corporation	74
Hensel Phelps	70	The Walsh Group	1
Herman & Kittle Properties, Inc	14	Thieneman Construction	77
HITT Contracting Inc.	23	Thompson Thrift	18
Holder Construction	3	Tishman Construction Company	103
HRP Construction	22	Titan Electric	15
Huen Electric, Inc.	86	Traylor Bros., Inc.	52
Hunt Construction Group	115	Turner Construction	65
Interstates Construction	90	USA FIRE PROTECTION	33
JE Dunn Construction	114	Voris Mechanical Inc	45
Jurgensen Companies	30	Weis Builders	13
Kiewit	54,55	Western Utility Contractors	48
Kiewit Energy Group	56	White Construction, Inc	27
Kokosing Construction Company	82		
Bold indicates Construction Advisory Council (CAC) member			

Thank you to Professor Clark Cory, CGT, for his assistance with this layout!

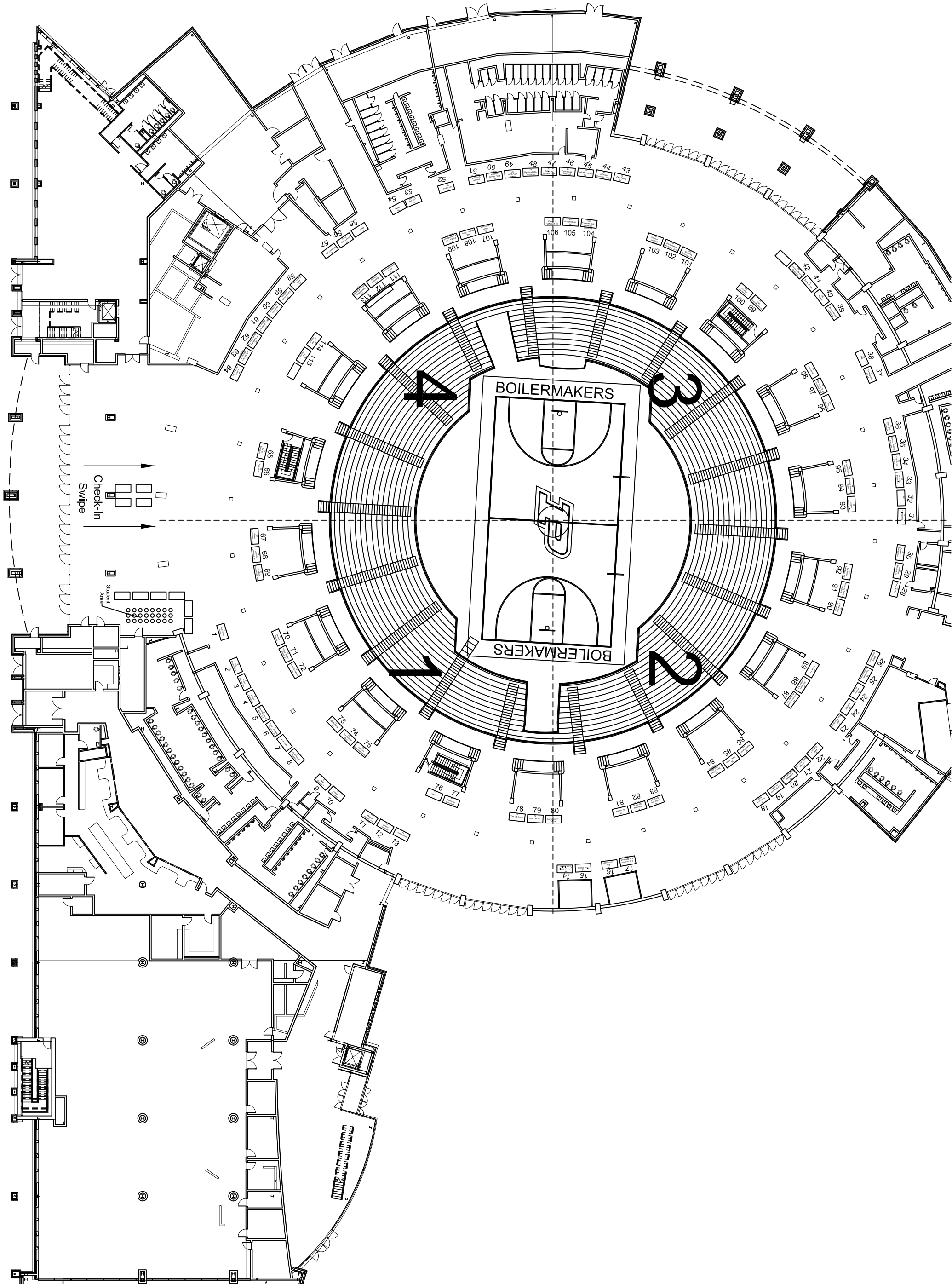



Building Construction Management
Fall 2013

9.27.2013

Booth #100

With nearly \$300M in annual revenues, Aldridge Electric is ranked among the nation's leading electrical contractors. Incorporated in 1952, we have more than 60 years of expertise completing complex transportation, drilling, mass transit, and power projects. A family-owned company headquartered in the Chicagoland area, Aldridge employs 600 employees on projects from coast to coast.

At Aldridge, we know the success of our company depends on the quality of our employees. Aldridge is committed to the development and enrichment of our employees. We want our people to expand their knowledge and fulfill their professional and personal goals. Aldridge, a highly trusted contractor, presents strong and experienced teams who fully understand the objectives and requirements of any project and pro...

<http://www.aldridge-electric.com>



Construction Advisory Council Member

Building Construction Management
Fall 2013

9.27.2013

Booth #64

Founded in 1940, Anning-Johnson Company is one of the largest specialty contractors in the United States. We have an industry-wide reputation for meeting and exceeding demanding quality requirements and satisfying the most rigorous schedules. We have the scale to provide quality specialty interior/exterior finish contracting anywhere in the United States.

Anning-Johnson Co. is an employee-owned company with management committed to our employee-owners. Our commitment is shown in several ways: training, to ensure our people are the best in the industry, providing an interesting and challenging work environment; and providing competitive salaries, benefits and returns on equity commensurate with our achievements.

<http://www.AnningJohnson.com>



Building Construction Management
Fall 2013

9.27.2013

Booth #50

The ARCO family of companies consists of eight construction companies and one mechanical company with offices in Chicago, St. Louis, Atlanta, Tampa, Philadelphia, Indianapolis, Cincinnati, and Kansas City. ARCO/Murray National Construction Company Inc. in Chicago opened in 2003 to service the Chicagoland area.

ARCO/Murray has professional, qualified, and experienced team of project managers who are capable of designing and building some of the most demanding projects. ARCO/Murray is comprised of three operational divisions: Build-to-Suit/National Accounts, Process, and Interiors. ARCO/Murray has constructed over 1500 projects in more than 400 cities, 41 states, and Canada. Approximately 75% of our annual revenue is with repeat customers.

<http://www.arcomurray.com>



Building Construction Management
Fall 2013

9.27.2013

Booth #87

Armstrong World Industries, Inc. is a global leader in the design and manufacture of innovative, stylish and environmentally conscious building materials, such as ceilings and floors for residential and commercial use.

<http://www.armstrong.com>

**BUILD
YOUR
FUTURE
WITH
ANNING
JOHNSON**



**NATIONAL COMMERCIAL SPECIALTY SUBCONTRACTOR
COME SEE US TODAY!
WWW.ANNING-JOHNSON.COM**

Anning-Johnson Company is an Equal Opportunity Employer



Austin Commercial
An Austin Industries Company

Austin Commercial is a recognized leader in commercial and institutional building, well known for delivering projects ahead of schedule and under budget. Recognized for landmark projects such as the LAX Tom Bradley International Terminal expansion, the UT Southwestern T. Boone Pickens Biomedical Building and Conference Center, Hunt Consolidated Headquarters and Museum Tower, Austin continues to lead the industry, serving our customers with innovative construction solutions and effect cost management strategies.

Building Construction Management
Fall 2013

9.27.2013

Booth #93

<http://www.austin-ind.com>



Through 40 years of construction and more than 9,000 projects under its tool belt, Baker has experience in virtually every type of concrete project imaginable, from commercial office buildings to heavy industrial power plants. Whether building one of the nation's premier athletic stadiums or framing a local parking structure, Baker's professional teams execute with drive, enthusiasm, and a winning can-do attitude to complete every project with excellence.

Construction Advisory Council Member

Building Construction Management
Fall 2013

9.27.2013

Booth #6

<http://www.bakerconcrete.com>

**Build Your Career
Build the World**



Austin Commercial is one of the largest builders in the US, providing innovative construction solutions to diverse markets.

We're hiring Interns and Graduates in:
Construction Management
Civil Engineering
Architectural Engineering



Austin Commercial
An Austin Industries Company

www.austin-ind.com/careers

Balfour Beatty Construction

Construction Advisory Council Member

Building Construction Management
Fall 2013

9.27.2013

Booth #59

Balfour Beatty Construction, Head-quartered in Dallas, TX, is one of the nation's largest commercial construction companies. We provide an extensive range of construction services, including construction management, general contracting, design-build, and preconstruction through more than 2,400 professionals nationwide. The company has been cited as one of the 100 Best Companies to Work For® by FORTUNE magazine for four years in a row.

If you are a student or alumni looking to start your new career or a professional expecting more from the place you work, it's time you learn more about Balfour Beatty Construction. We offer more variety, bigger opportunities, and greater long-term fulfillment. Learn more about us at www.balfourbeattyus.com.

<http://www.balfourbeattyus.com>



Barnard Construction Company, Inc., based in Bozeman, Montana, is a heavy-civil construction company with projects underway across North America. We specialize in dam, reservoir and hydro construction and rehabilitation, power transmission and distribution, tunneling, inland marine, oil, gas, utility, and sewer and water pipeline projects. We offer competitive salaries, opportunities for stock ownership, profit sharing, 401(k)s, a generous health plan, annual bonuses, and challenging career opportunities with a financially solid company. Barnard's people are the reason for the success of the company. At Barnard, we build the riskiest, most difficult, complex jobs we can find and we hire people who thrive on tough work and demanding opportunities.

Building Construction Management
Fall 2013

9.27.2013

Booth #51

<http://www.barnard-inc.com>



Barnhart enjoys a nationwide reputation for solving problems. We specialize in the heavy lifting and heavy transport of major components used in American industry. Barnhart is committed to continuous improvement and to be the best heavy lift and heavy transport company. Our customer can expect Barnhart to aggressively pursue innovative ways to lower overall project costs and improve safety.

- Over 25 branches across the U.S.
- The strongest network of rigging experts and equipment in the country.
- Barnhart's network includes a long list of "cool tools" including PSTe Goldhofer trailers, cranes from 8.5 to 1,760 tons, slide systems, strand-jacks, and the Modular Lift Tower.

Building Construction Management
Fall 2013

9.27.2013

Booth #95

<http://www.barnhartcrane.com>

Barton Malow

Building Construction Management
Fall 2013

9.27.2013

Booth #39

Barton Malow Company provides construction management, design-build, program management, general contracting, technology and rigging services throughout North America. Our national network of offices delivers new construction, renovation and expansion projects across the country within markets of expertise including: healthcare, higher education, industrial, energy, federal, K-12 education and sports/special event facilities.

<http://www.bartonmalow.com>



BLACK & VEATCH

Black & Veatch is a global leader in the consulting, engineering, construction and operation of what the world needs now and in the future in the crucial areas of energy, water and telecommunications and in providing up-to-the-minute services in the fast changing federal and environmental markets. Founded in 1915, the employee-owned, \$2.3 billion company operates out of over 110 offices worldwide and has completed projects in more than 100 countries.

Building Construction Management
Fall 2013

9.27.2013

Booth #109

<http://www.bv.com>



BMW CONSTRUCTORS, INC.

Construction Advisory Council Member

Building Construction Management
Fall 2013

9.27.2013

Booth #72

BMW Constructors, Inc. is an extremely focused industrial contractor performing multi-million dollar capital projects, in-plant maintenance, turnarounds and outages throughout the Midwest regions.

While we perform a wide array of services, our core service lines include process piping, pipe fabrication, high purity piping, welding, steel erection, boiler maintenance, sheet metal and other construction-related services.

Since 1955, BMW Constructors, Inc. has evolved into a process-driven company providing repeat service to a prestigious list of "blue chip" customers in the petrochemical, refining, pharmaceutical, chemical, biotechnology, power generation, semiconductor, food processing, metals, hospitals, healthcare and manufacturing industries.

<http://www.bmwc.com>



Construction Advisory Council Member

Building Construction Management
Fall 2013

9.27.2013

Booth #67

Founded in 1967, Bowen Engineering Corporation is an experienced self-performing general contractor with operation centers located in Indiana, Ohio, Maryland, Texas, and West Virginia. Bowen spent its earlier years as an innovative builder of water and wastewater treatment plants. Now, Bowen has established itself in the power, industrial, and private utility markets.

Bowen is seeking Project Engineers who have a passion for construction and who want to develop their career through first hand field experience on some of the most exciting and challenging projects in the U.S.

Successful candidates will be backed by the rewards and benefits of working for an employee-owned company, and will gain exposure and opportunities they won't find elsewhere.

<http://www.bowenengineering.com>

Brandenburg

Construction Advisory Council Member

Building Construction Management
Fall 2013

9.27.2013

Booth #113

Brandenburg, established in 1968, is the nation's largest demolition firm with a staff in excess of 600 full-time permanent employees. Brandenburg provides comprehensive asset retirement services for total plant closure as well as selective demolition designed to enhance the efficiency and profitability of ongoing plant operations. Brandenburg self-performs associated services including electrical and mechanical utility construction and relocation, equipment salvage and rigging, scrap management, environmental assessments and remediation.

<http://www.brandenburg.com>



Join a national, employee-owned team of contractors ready to give you boots on the ground experience with world class construction projects

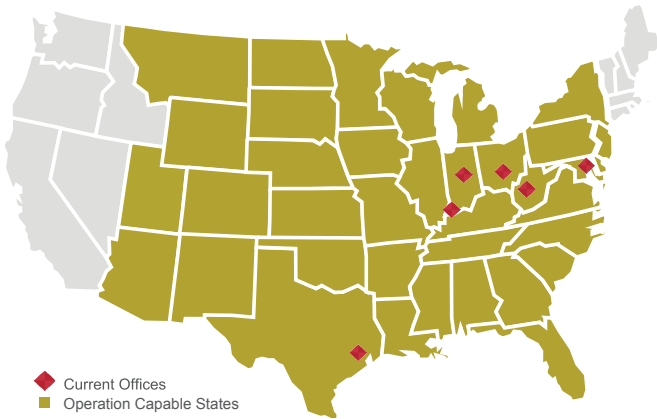

45+ YEARS IN BUSINESS

700
EMPLOYEES

77 EMPLOYEE OWNERS



“Coming out of college, I knew I didn’t want to be stuck behind a desk processing papers for a jobsite I would rarely see. At Bowen I spend most of my time in the field, directly affecting the jobs I’m working on. Bowen is that perfect size - providing large challenging projects, while still being small enough to directly value me and my contribution.”

Tyler Shaw, Bowen Project Engineer



www.bowenengineering.com

317.842.2616



CBRE Group, Inc. (NYSE:CBG), a Fortune 500 and S&P 500 company headquartered in Los Angeles, is the world's largest commercial real estate services and investment firm (in terms of 2012 revenue). The Company has approximately 37,000 employees (excluding affiliates), and serves real estate owners, investors and occupiers through more than 300 offices (excluding affiliates) worldwide. CBRE offers strategic advice and execution for property sales and leasing; corporate services; property, facilities and project management; mortgage banking; appraisal and valuation; development services; investment management; and research and consulting. Please visit our website at www.cbre.com.

Building Construction Management
Fall 2013

9.27.2013

Booth #89

<http://www.cbre.com>



CG Visions is the leading provider of turn-key outsourced CAD and "Building Information Modeling" (BIM) solution implementation and consulting. CG Visions is also the developer of "BIM Pipeline", a web based, rules driven, Material Management system that utilizes Building Information Modeling (BIM) data to directly drive detailed take offs. Pipeline enables builders to leverage BIM data to create full master plan estimates with delta BOM reports for options, lot specific as built reports to directly cut purchase orders and even capture customer specific changes to track client customizations, all independent of the source of the BIM data. Pipeline can consume & refine BIM data from multiple BIM applications and also integrates with popular back office and sales systems.

Building Construction Management
Fall 2013

9.27.2013

Booth #81

<http://www.cgvisions.com>



Construction Advisory Council Member

CITGO Petroleum Corporation is an American success story that originated back in 1910 when pioneer oilman Henry L. Dougherty created the Cities Services Company. In 1965, Cities Services decided to change its marketing brand and introduced the name CITGO. They retained the first syllable of its long-standing name and ended with CITGO to imply power, energy and progressiveness. The now famous and enduring CITGO logo was born.

Now more than four decades later, CITGO is in the top rank of petroleum marketers in the United States, and one of the nation's top marketers of gasoline. We are a world-renowned supplier of diesel fuel, jet fuel, kerosene, lubricants, greases, waxes, petrochemicals and industrial products.

Building Construction Management
Fall 2013

9.27.2013

Booth #61

<http://www.citgo.com>



Clayco is a full-service real estate development, design and construction firm specializing in the art and science of building.

Clayco provides design-build project delivery nationwide for government, corporate, industrial, institutional, residential markets, and banking institutions.

Our people are our greatest asset, we offer each employee the opportunity to grow with Clayco. We demonstrate our commitment to employees through excellent benefit packages, professional development, advancement and the opportunity to give back to the community.

Building Construction Management
Fall 2013

9.27.2013

Booth #76



The people who make up Clayco are what gives our company the competitive advantage and makes us stand out to

<http://www.claycorp.com>

Beyond these Walls

As we view these structures through the eyes of their owners, we don't see buildings. We see centers of healing, technology, science, research, manufacturing, entertainment, and progress. We are the builders of people's lives.

CONNECT WITH US
claycorp.com



CLAYCO

THE ART & SCIENCE OF BUILDING

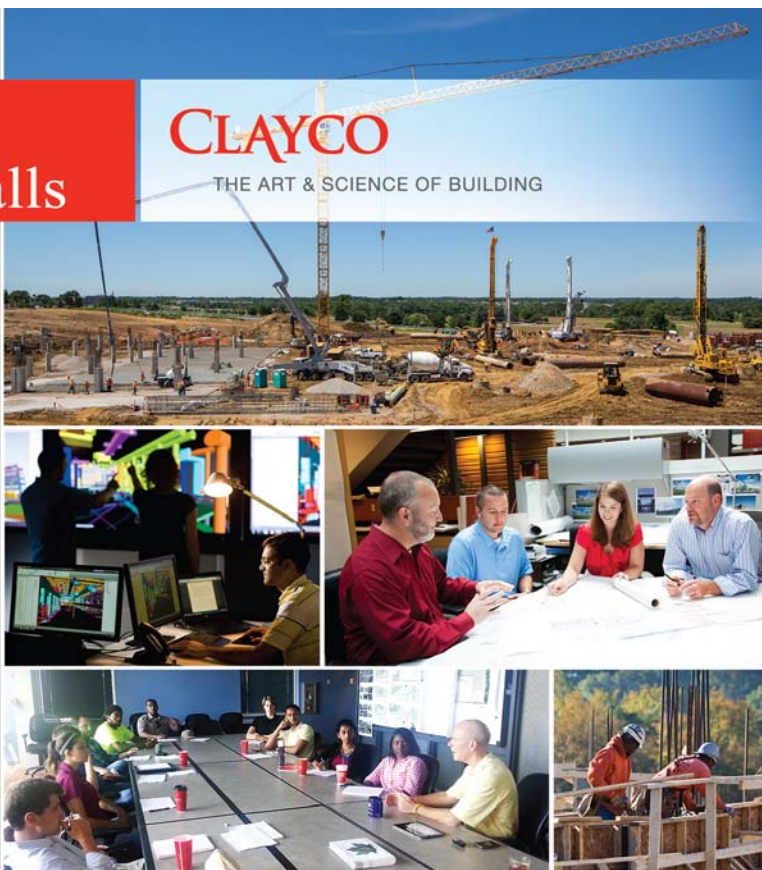

CLUNE

Construction Company

Clune Construction Company is a national company with full-service offices in four major U.S. cities plus satellite offices in most regions. Clune Construction Company strives to turn an interior space into an ennobling working environment, and we honor the people who then thrive and function in that environment. We passionately serve professionals and clients who maintain quality in everything they do, and who appreciate the difference-working with a partner who shares a rock-solid belief in sound ethics, professionalism and can-do spirit.

Building Construction Management
Fall 2013

9.27.2013

Booth #107

<http://www.clunegc.com>

college pro

For over 40 years, College Pro has been giving students and recent graduates real-life management experience by giving them the opportunity to run their own business for the spring and summer. College Pro is a franchise painting company with over 500 student managers operating in 25 states.

Building Construction Management
Fall 2013

9.27.2013

Booth #31

<http://www.collegepro.com>



CORPORATE INTERIORS
RENOVATIONS
HEALTHCARE
MISSION CRITICAL
EDUCATION
VIRTUAL CONSTRUCTION
RETAIL

An award-winning company starts with the right people

QUALITY AND INTEGRITY ONE SQUARE FOOT AT A TIME

Chicago | Los Angeles | New York | Washington DC
www.clunegc.com



Connelly Electric Co. is an electrical contractor who provides unparalleled installation and service for all Electrical Construction, Fire Alarm, Voice/Data, and Alternative Energy Systems. In addition, we also provide Electrical Engineering Services for Design/Build Installations. Our diverse customer base includes general contractors, developers, construction managers, educational, institutional and government administrators, and business owners.

Our design build engineering team will construct a budget conscience plan to save clients valuable time without compromising quality. To help streamline the construction process, we utilize Building Information Modeling (BIM) where 3D coordination is necessary. Connelly Electric also has LEED Accredited Professionals on staff, helping our clients understand the long-term benefits resulting from a well-planned, LEED certified project.

Building Construction Management
Fall 2013

9.27.2013

Booth #53

<http://www.connellyelectric.com>



Consigli, a fourth generation family-owned business, established in 1905, is a full-service construction manager and general contractor serving academic, healthcare, institutional, life sciences, corporate, landmark restoration and government clients throughout New England and New York State. A leader in sustainable construction practices, Consigli is consistently ranked in the national Top 100 Green Contractors by Engineering News-Record Magazine. With offices in Massachusetts, Maine, New York and Connecticut, Consigli has been recognized year after year as one of the best places to work by The Boston Globe, Boston Business Journal, and MaineBiz.

Building Construction Management
Fall 2013

9.27.2013

Booth #21

<http://www.consigli.com>

ENGINEERING YOUR FUTURE!



40 S. ADDISON ROAD SUITE 100
ADDISON, IL 60101
P 630-543-9059-F 630-543-9077
www.connellyelectric.com



CPM Construction Planning and Management, Inc. is a General Contractor/Construction Management company who has been in business for over 30 years and typically works within a 300 mile radius of Indianapolis, Indiana. CPM has an outstanding reputation in the construction industry and has consistently been selected as one of the top 25 General Contractors in the Indianapolis area by the Indianapolis Business Journal. Our commitment to quality and efficiency, combined with a professional staff of Estimators, Project Managers, Superintendents, ensures the quality and service integrity our clients expect.

Building Construction Management
Fall 2013

9.27.2013

Booth #96

<http://www.cpmconstruction.com>



In 1969, what started out with a handful of trucks and a few employees has grown into the 4th largest disaster cleanup company. Today, CRC has offices throughout the southeast and employs over 250 full-time employees. CRC handles fire damage, flood damage, storm damage, hurricanes, tornados, and all types of emergencies. CRC has experienced explosive growth over the last eight years and has been recognized by many national sources. Business Leader magazine has ranked CRC number #1 three years in a row and Qualified Remodeler magazine ranked CRC 20th out of the top 50,000 contractors in the U.S. Our goal is simple: to be the most desired company in the United States. Come join our exciting team!

Building Construction Management
Fall 2013

9.27.2013

Booth #38

<http://www.callcrc.com>



Construction Advisory Council Member

Building Construction Management
Fall 2013

9.27.2013

Booth #112

Cupertino Electric is a private company headquartered in San Jose, Calif. that has provided expert engineering and construction services for a constantly evolving world for more than 59 years. Cupertino designs and installs custom electrical solutions for clients in a variety of industries, including alternative energy, biotech, commercial, data center, education, energy infrastructure, gaming, healthcare, hospitality, manufacturing and retail. The company's Energy Alternatives Division engineers, procures, constructs and maintains renewable energy solutions. For more information, visit www.cei.com.

<http://www.cei.com>



Construction Advisory Council Member

Building Construction Management
Fall 2013

9.27.2013

Booth #9

DPR Construction

BCM Industry Partner (CAC Member)

We are a unique technical builder with a passion for results. Ranked in the top 50 general contractors in the country over the last 10 years, we are a national commercial general contractor and construction manager that has grown with our customers by delivering measurably more value. With the purpose of building great things—great teams, great buildings, great relationships—DPR is a truly great company. Our relentless accountability, proven technical expertise, and collaborative approach allow us to provide a higher level of quality service on projects of all sizes and complexities, whether it's a multi-million-dollar technical facility or the renovation of a single office.

<http://www.dpr.com>



Building Construction Management
Fall 2013

9.27.2013

Booth #41

Drees Homes ranks as the twenty-third largest homebuilder in the country as well as the eighth largest privately-owned homebuilder in the country.

Our company's mission is to be America's leading private homebuilder. We are focused on delivering to our customers the home and features that they uniquely desire with the craftsmanship, durability and an 85-year reputation that's uniquely Drees.

Drees has been recognized with many prestigious industry honors, including the home building industry's equivalent of the Triple Crown, winning all three major industry awards: America's Best Builder in 1998 and again in 2008; the National Housing Quality Award in 1994; and National Builder of the Year in 1991.

<http://www.dreeshomes.com>



Building Construction Management
Fall 2013

9.27.2013

Booth #42

Dugan & Meyers was founded in 1935 and operates in three locations: Cincinnati, OH, Columbus, OH and Louisville, KY. We strive to recruit top students whom we can entrust with challenging assignments that complement the student's education and post-graduation career goals. At Dugan & Meyers, we work as a General Contractor as well as a Construction Manager. We also do a limited amount of Design/Build work and have the ability to self-perform work, including high profile concrete structures, and mechanical work for Water and Waste Water Treatment Plants.

<http://www.dugan-meyers.com>



E&B Paving provides world-class solutions to customers from ten area offices, 14 permanent asphalt and concrete plants, and several portable asphalt and concrete plants. Our distinguished client list includes hundreds of federal, state, county and local governments and agencies; general contractors; commercial, residential and industrial developers; and private businesses of all sizes.

Our paving and consulting services can be applied to highways extending thousands of lane miles or to parking lots accommodating a few dozen vehicles and everything in between.

Building Construction Management
Fall 2013

9.27.2013

Booth #43

<http://www.ebpaving.com>



Construction Advisory Council Member

Comprehensive, Best-In-Class Interior and Exterior Construction Services

Ever since we opened our doors in 1956, E&K has been uncompromising in the commitment to deliver the highest quality products and services our clients demand, anywhere they need them. Today, we're one of the largest interior/exterior finish contractors in the U.S., with offices throughout the country and a reputation for excellence. At E&K, only the best in class will do. We've built our reputation on providing a level of quality, service and value that exceeds client expectations.

Building Construction Management
Fall 2013

9.27.2013

Booth #58

<http://www.e-kco.com>



Construction Advisory Council Member

For years Executive Construction Inc. has brought extensive expertise and effective results to a wide range of commercial and institutional general contracting and construction management assignments. ECI's projects, comprising more than 60 million square feet since the firm's inception in 1974, range from \$10,000 to \$40 million in construction costs. The firm has generated over \$100 million in revenue for each of the last five years.

Building Construction Management
Fall 2013

9.27.2013

Booth #60

<http://www.ecibuild.com>



Construction Advisory Council Member

With over 1,500 employees and over 90 years of construction experience, Wilhelm is recognized as one of the largest contractors in Indiana. Specializing in commercial and industrial construction, Wilhelm offers: pre-construction, construction management, general contracting, design/build, and trade contracting services.

We do the following work with our own forces: earthwork, selective demolition, concrete, masonry, miscellaneous and structural steel, carpentry, equipment installation, and through affiliate companies who provide mechanical, HVAC, electrical construction, and test and balance work. These capabilities give Wilhelm the flexibility to perform most of the work on projects providing enhanced value to our clients and superior schedule and quality control.

Building Construction Management
Fall 2013

9.27.2013

Booth #62

<http://fawilhelm.com>



F.H. Paschen, S.N. Nielsen is a large and respected general contractor in the Midwest, providing specialists in every phase of construction from planning through completion. In addition to the company headquarters in Chicago, Illinois, F.H. Paschen, S.N. Nielsen has offices in New Orleans, Louisiana; Falls Church, Virginia; and Miami, Florida.

Building Construction Management
Fall 2013

9.27.2013

Booth #17

<http://www.fhpaschen.com>



Agricultural post-frame building company established in 1958 we build buildings for farms, equine, poultry, beef, suburban and retail. 80% of our business is Agricultural.

Construction Advisory Council Member

Building Construction Management
Fall 2013

9.27.2013

Booth #73

<http://www.fbibuildings.com>



FCI Constructors, Inc. was founded in 1978 by M.L. "Bud" Francis and was originally named Francis Constructors, Inc. FCI has grown from a small family-owned business to an ENR Top 400 Contractor and is now an employee-owned company. FCI began in Grand Junction, CO and now has five additional offices throughout Colorado, Arizona, Wyoming, and New Mexico. FCI is a commercial / light industrial Construction Manager and General Contractor building projects throughout the "Four Corners" States and the Southwest U.S.. Annual volume is approximately \$280 million. Projects are mostly commercial and include: schools, fire stations, detention facilities, churches and municipal buildings. Projects range in size from \$500,000 to \$40,000,000 with an average project size of \$5-10 million.

Building Construction Management
Fall 2013

9.27.2013

Booth #24

<http://www.fciol.com>



Finch Constructors, Inc. (FINCH) is a family owned and operated business which provides Mechanical, Electrical, and Construction Management services to commercial and industrial clients throughout the Midwest since 2002. FINCH is a Nationally Certified Minority (MBE), Disadvantaged (DBE), and Veteran Business Enterprise (VBE) based in Indianapolis, IN. There are currently 62 employees in the Indianapolis office.

Construction Advisory Council Member

Building Construction Management
Fall 2013

9.27.2013

Booth #111

<http://finchconstructors.com>



As the leading manufacturer of superior commercial roofing solutions, Firestone Building Products Company, LLC has been trusted by contractors, building owners and specifiers for 30 years. The company has steadily diversified from a single product to a full line manufacturer of EPDM, thermoplastic, asphalt and metal roofing systems, polyiso insulation and accessories.

Building Construction Management
Fall 2013

9.27.2013

Booth #91

<http://www.firestonebpco.com>



Frontier Industrial Corp is a full service, nationwide contractor working in the areas of Brownfield Redevelopment, Asset Recovery and Demolition/Dismantling.

We specialize in acquiring distressed properties and putting them back into productive reuse.

At Frontier we work closely with our Clients and Partners to create a project strategy and management plan that mitigates structural and remediates environmental concerns. Our objective with each property is to its increase value and bring it back to productive use.

Building Construction Management
Fall 2013

9.27.2013

Booth #94

<http://www.fic-services.com>

Firestone
BUILDING PRODUCTS

NOBODY COVERS YOU BETTER.™



Gaylor Inc. is in the top 25 electrical contractors in the United States. We have offices nationwide and specialize in electrical contracting.

Construction Advisory Council Member

Building Construction Management
Fall 2013

9.27.2013

Booth #66

<http://www.gaylor.com>



GE Johnson Construction Company

BCM Industry Partner (CAC Member)

Construction Advisory Council Member

Building Construction Management
Fall 2013

9.27.2013

Booth #63

GE Johnson Construction Company is located in Downtown Colorado Springs, CO at the base of Pikes Peak Mountain. Founded by Gil Johnson in 1967, we are a General Contractor.

Our Vision, and that of many of our clients, is focused on the long view. "We must strive to develop relationships, earn a reputation for unparalleled construction services and provide teams dedicated to delivering results that exceed expectations." With revenues between \$250M to \$350M annually, we are a commercial contractor specializing in building the following facilities: Hospitals, Mountain Resorts, Educational, Criminal Justice, Commercial Office, and Advanced Technology. Traditionally, 85% of our work comes from repeat customers.

<http://www.gejohnson.com>



Building Construction Management
Fall 2013

9.27.2013

Booth #35

Gilbane began in 1873 as a family-run carpentry and general contracting business. Since then the company has grown into one of the nation's largest full-service construction firms. The Midwest Regional Office provides construction management, program management, design-build and general contracting services. The region currently has over 180 employees across five states - Illinois, Wisconsin, Missouri, Iowa and Minnesota. Some of our most notable projects are: Elmhurst Memorial Hospital, University of Chicago Medical Center, Joliet Junior College, and SC Johnson Project Honor. What truly sets the company apart is that Gilbane lives the core values handed down by its founding fathers. Gilbane is focused on acting as a steadfast advocate for its customers and creating relationships gr...

<http://www.gilbaneco.com>



It started with two engineers, David Harvey, Sr. and Gerald D. Hines. It started over 55 years ago in 1957. Misters Hines and Harvey started their companies together and for the same purpose. They designed, constructed, owned and maintained some of the finest projects in the country. The best design talent was brought in and it produced monumental and lasting architecture. Lessons were learned along the way. Best practices were established. Standards were set. The people of Harvey-Cleary in 2013 are a modern version of the original concept. Harvey-Cleary serves the Washington D.C. metro area for both base and interiors projects. We share the culture of building to the highest standard and serving an owner whose goals for the project are the same as ours. This is the Harvey-Cleary cultu...

Building Construction Management
Fall 2013

9.27.2013

Booth #108

<http://www.harveycleary.com>

The Highest Performing Complete National Electrical Contractor



"Gaylor, Inc. is a multi-million dollar design/build specialty contractor founded in central Indiana with our largest branch located in Noblesville. We are bonded, insured, and licensed in 31 states to provide full service design. electrical, industrial, utility, low voltage and 24-hour maintenance services for our clients. We work in almost all commercial markets and pride ourselves as being one of the most progressive, high tech companies in the country with the dedicated skills and capabilities needed to help our clients meet their goals of productivity and profitable in today's extremely competitive markets."

Gaylor, Inc.

1.800.878.0577

www.gaylor.com

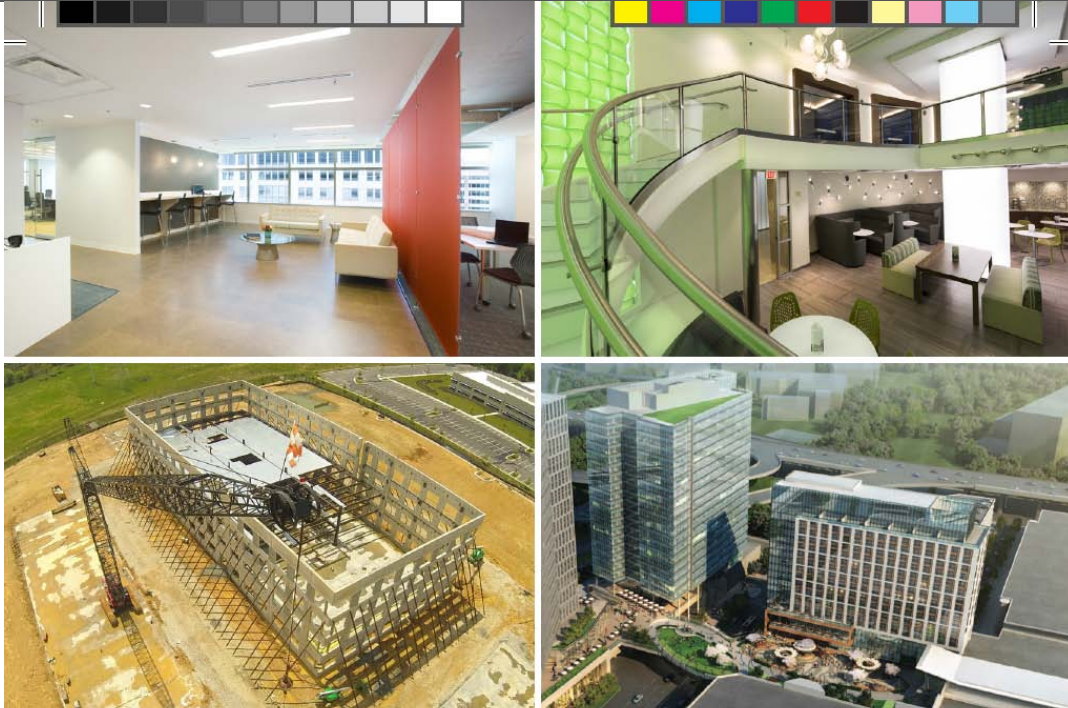

General Contracting • Construction Management
Design/Build • Base Building
Tilt-Up Construction • Interiors • Renovations

**HARVEY...
CLEARY**
Innovation, Quality, Integrity

www.harveycleary.com



Hays & Sons Complete Restoration is a full service restoration and reconstruction company that has built its reputation on one thing...the customer. After more than thirty years in the business, we understand the emotional turmoil, stress and frustration our customer's face during their time of crisis.

As your local expert in handling water, fire and smoke, and storm damage to your residential or commercial property, our team of 115 caring and compassionate employees will assist you with timely emergency response support, flawless reconstruction services, careful restoration of your property and possessions and a commitment to your complete and total satisfaction.

Building Construction Management
Fall 2013

9.27.2013

Booth #84

<http://www.haysandsons.com>



Helix Electric is one of the largest, most successful open-shop electrical contractors specializing in design-build and highly complex electrical projects across the nation. Our services encompass virtually all facets of electrical construction including mission critical, commercial and retail, government and military, industrial, transportation, and renewable energy. We have a strong reputation, an extensive network of customer relationships, and have consistently provided cutting-edge product innovations.

Building Construction Management
Fall 2013

9.27.2013

Booth #79

<http://www.helixelectric.com>

Hays & Sons

Complete Restoration

CONSTRUCT YOUR CAREER

Commercial • Correctional • Design-Build • Educational
Government • Healthcare & Biotech • Hospitality • Industrial
Mission Critical • Renewable Energy • Residential • Transportation

careers@helixelectric.com



HELIX ELECTRIC
CONSTRUCTORS • ENGINEERS



Construction Advisory Council Member

Building Construction Management
Fall 2013

9.27.2013

Booth #70

Hensel Phelps is an employee-owned company. Since 1937, we have developed from a local builder in Greeley, Colorado into a \$3 billion per year national contractor with an exciting portfolio of successful projects. Consistently ranked in the top 50 for domestic construction, we build a diverse range of project types: new construction/renovation of commercial office, airport, correctional, public assembly, sports, healthcare, educational, institutional, public buildings, mixed-use, retail, hospitality, transportation, entertainment, microelectronics, and laboratories. With over 75 years of experience, Hensel Phelps has retained its core values of ethical business practices, paired with one of the strongest records in the industry for on-time delivery and cost-effective performance.

<http://www.henselphelps.com>



Building Construction Management
Fall 2013

9.27.2013

Booth #14

Herman & Kittle Properties, Inc is a vertically integrated real estate development firm. We have business groups for land development, design, construction and property management. Our portfolio consists of self storage, market rate and affordable apartment communities in 12 states.

<http://www.hermankittle.com>



Building Construction Management
Fall 2013

9.27.2013

Booth #23

With modest beginnings in 1937 as a small family business run from the dining room table of Warren and Myrtle Hitt, HITT Contracting Inc. has grown to be among the top 100 largest general contractors in the United States.

From a small family house in Arlington, Virginia to offices in Washington, D.C., Atlanta, Baltimore, South Florida and Charleston, our steady growth over the past 75 years can be attributed to the longstanding relationships we develop with our clients.

<http://www.hitt-gc.com/>



Construction Advisory Council Member

Building Construction Management
Fall 2013

9.27.2013

Booth #3

Holder Construction Company

Holder Construction Company is a nationally leading Commercial Construction Company consistently ranking in the Nation's Top 100 contractors. Since 1960, our company's focus is on strong relationships and top quality buildings which have resulted in over 80% repeat client business, a list including major Fortune 500 companies and experience spanning across 33 states. It is our mission not to be the biggest, but always the best.

We pride ourselves on our people and our strong company culture. Holder has been listed in the Top 25 Best Medium Companies to work for since 2004, and consistently works with our associates to maintain that reputation.

We are interviewing for Management and Field Supervision Interns and Fulltime Associates.

<http://www.holderconstruction.com/Pages/default.aspx>



Building Construction Management
Fall 2013

9.27.2013

Booth #22

HRP Construction Inc. is a solid, aggressive, and growth oriented water, wastewater, and heavy-highway contractor. We enjoy our highest levels of success seeking and building projects of an unusual, complex, and/or difficult nature and scope. We have achieved success in many forms: continued growth, unprecedented financial strength for a firm of our size, an award winning safety program and record, and an exceptional reputation for competency, quality, honesty, and unmatched and relentless service.

All of this is possible only because we are blessed with such extraordinary people. Knowing that more good people are the key to our continued success, we continually seek prime candidates for permanent field and office leadership positions, and for summer internships.

HRP Construction ...

<http://www.hrpconstruction.com>



Building Construction Management
Fall 2013

9.27.2013

Booth #86

Huen Electric, Inc. is a well established, Chicago based 400+ person electrical construction firm with offices nationwide. With over 30 years in business, Huen has earned a reputation as a dynamic, proactive, and resourceful electrical contracting and engineering company. Huen's high level of commitment to clients and the community has helped the company build a loyal customer base.

Huen specializes in electrical construction, engineering, and design-build services for owners, general contractors, developers, construction managers, and architects. Clients request our design-assist, design-build, engineering, and installation expertise for projects across all markets such as: healthcare, higher education, mission critical, renewable energy, specialty arts and entertainment venue...

<http://www.huenelectric.com>



Construction Advisory Council Member

Building Construction Management
Fall 2013

9.27.2013

Booth #115

The Hunt Construction Group team spans across the entire country, and comprises of over 700 employees. Whether located in a Hunt regional office or on a jobsite, our relationship-oriented work environment shines through; every Hunt employee is valued, appreciated and treated with respect.

We have been in the construction industry for nearly 70 years with tangible, positive results that we do the job right. The Hunt team works to create strong client-relationships, and we emphasize quality and skill-utilization in every aspect of construction, no matter the type of project.

Specialties: Building Information Modeling (BIM), Construction Management, Design-Build, Diversity Development, General Contracting, Integrated Project Delivery, Preconstruction, Sustainability, Workplace Sa...

<http://www.huntconstructiongroup.com>



Building Construction Management
Fall 2013

9.27.2013

Booth #90

Interstates specializes in the design and installation of electrical systems for industrial processing plants and commercial buildings.

Our experience spans many industries. We have been able to offer our expertise in electrical design and studies; automation system design, development, and installation; instrumentation design, procurement, installation, and maintenance; and electrical system installation to hundreds of satisfied customers.

<http://www.interstates.com>



Construction Advisory Council Member

Building Construction Management
Fall 2013

9.27.2013

Booth #114

Headquartered in Kansas City, MO, JE Dunn Construction is an employee owned commercial general contractor with expertise in construction mgmnt, program mgmnt and design-build projects. With a volume of \$2 billion for 2011, we are ranked as the 16th largest general building contractor in the nation by Engineering News-Record.

We are committed to the people that make this company a success. We feel our greatest asset is the relationships we have with with others. Over 80% of all our business is derived from existing or referral client relationships. This speaks volumes about the quality of the projects we build and the depth of our services.

<http://www.jedunn.com>



Building Construction Management
Fall 2013

9.27.2013

Booth #30

The Jurgensen Companies are a family owned business group which primarily focuses on highway and commercial construction. The company is vertically integrated with aggregate and asphalt hot mix facilities that support the construction operations and supply outside users.

The company was formed in the 1930's and is now in its third generation. The primary area of operations is in Ohio, Kentucky and Indiana. The home office is located in Cincinnati, Ohio and supports the subsidiary operations and plants. Our scope of work encompasses interstate highway construction, commercial construction, utility construction, and the production of asphalt paving materials and aggregates.

The company also produces asphalt paving materials and aggregates for commercial and retail sales.

<http://www.jrjnet.com>



Building Construction Management
Fall 2013

9.27.2013

Booth #54,55

Excellence. It is the foundation of everything we do. What began in 1884 with two hardworking brothers has grown into a Fortune 500 construction, mining and engineering powerhouse.

Kiewit's ethical, forward-thinking workforce continues to build upon the company's reputation of safe, high-quality engineering. Consistently ranked among the top five of the Engineering News-Record Top 400 Contractors, our company is a leader in a variety of market sectors throughout North America and, most recently, Australia.

As an employee-owned company, Kiewit's assets are managed by the people who know our work best. For us, business is personal. As our own stakeholders, we're invested in every project we take on. We continuously strive to build high-quality work at the lowest cost.

www.kiewit.com



Building Construction Management
Fall 2013

9.27.2013

Booth #56

Kiewit Energy Group is one of four business divisions of Kiewit Corporation focusing on the design & construction of industrial energy projects from oil, gas, & chemical plants to combustion turbine power plants & large offshore drilling operations. Kiewit is the 3rd largest general contractor in the United States, a Fortune 250 company, consistently ranked among the top five of the Engineering News-Record Top 400 Contractors, employee-owned, & a leader in the construction, mining and engineering industries. Kiewit has employment opportunities within 34 independent business units across North America & Australia covering four major market groups: Building, Energy, Infrastructure & Mining.

<http://www.kiewit.com>



Kiewit



Kokosing Construction Company, Inc. is Ohio's largest self-performing general contractor with over 60 years of experience in constructing industrial buildings, industrial manufacturing and process plants, water and wastewater treatment facilities, roads and bridges, underground utility systems and marine construction. Kokosing and its affiliated companies employ over 2,000 people. We have been named in Engineering News Record's 2013 issue as the 68th largest contractor in the nation.

Building Construction Management
Fall 2013

9.27.2013

Booth #82

<http://www.kokosing.biz>



Kvaerner North American Construction Inc is the direct hire union construction company of Kvaerner in the United States. Kvaerner North American Construction is a premier provider to the power, process and steel industries with offices in Canonsburg, PA, and Hammond, IN in addition to a pipe fabrication facility in Hammond, IN.

Kvaerner NAC is a subsidiary of Kvaerner ASA, an international contractor specializing in engineering, procurement and construction ("EPC") for offshore platforms and onshore plants. Kvaerner plans and executes some of the world's most demanding projects as a preferred partner for upstream and downstream oil and gas operators, industrial companies and other engineering and fabrication contractors.

Building Construction Management
Fall 2013

9.27.2013

Booth #104

<http://www.kvaerner.com>



Layne Heavy Civil, Inc., is a division of the publicly traded company Layne Christensen Company (LAYNE) (NASDAQ:LAYN). Layne is a global water management, construction and drilling company. We provide responsible solutions for water, mineral and energy challenges. Layne Heavy Civil is recognized today as one of the nation's leading water resource contractors, offering innovative project design and construction.

Building Construction Management
Fall 2013

9.27.2013

Booth #80

<http://www.layne.com>



We're a diversified construction company, made up of teams of people who are proven in their industries. All working to design, build, transport, operate, and maintain projects all over North America. But we believe that projects are about more than concrete and steel. They're about people and the power of partnerships. Partnerships with our employees, our communities, our contractors and clients.

We believe in building trust in the places where we do business—whether that's by engaging honestly, by giving back, by putting safety first, or by looking for smarter, more sustainable ways to get the job done right.

Building Construction Management
Fall 2013

9.27.2013

Booth #12

<http://www.ledcor.com>



LAYNE HEAVY CIVIL, INC.

JOIN OUR TEAM OF EXPERTS.

We offer **sustainable solutions** in answer to today's water infrastructure challenges.

Layne Heavy Civil, Inc., a subsidiary of the Layne Christensen Company (Layne), is one of the premier water resource contractors in the United States, offering innovative project design and construction.

Our services consist of :
water supply, water and wastewater treatment plants,
pipelines, renewable energy, deep shafts and tunnel systems,
and marine construction.

For more information on our broad range of **services and expertise** please visit our website.

To contact a team member in your area , please contact Sylvia Adams at sylvia.adams@layne.com

www.layne.com



Construction Advisory Council Member

Building Construction Management
Fall 2013

9.27.2013

Booth #7

Lend Lease is one of the world's leading fully integrated property and infrastructure solutions providers, with strong development, investment management, project and construction management and asset and property management capabilities.

Founded in Sydney in 1958 by Dutch immigrant and innovator Dick Dusseldorp, the group was born out of a vision to create a company that could successfully combine four disciplines; property, financing, development and investment.

Lend Lease's aim is to be the leading international property and infrastructure group.

<http://www.lendlease.com>



Building Construction Management
Fall 2013

9.27.2013

Booth #19

At Liberty Mutual Insurance, doing the right thing is essential. That's why we offer a diverse range of student opportunities that complement your academics, and provide experience through immediate responsibility and stimulating work.

As a Fortune 100 company, we have the resources and training for you to expand your skills, knowledge, and creativity to drive our business forward. A diversified global insurer, LMI employs over 50,000 people in more than 900 offices worldwide. With 36.9 million in annual consolidated revenue, LMI is the U.S.'s 3rd largest property and casualty insurer.

Responsibility. What's your policy?

<http://www.libertymutualcampus.com/>



Marking Services, Inc. (MSI) is a US-based company that provides labeling services to the oil, gas, offshore drilling, food and beverage, industrial and power generation industries worldwide. Headquartered in Milwaukee, Wisconsin USA, the company also has manufacturing and engineering centers in Houston, Singapore, Edmonton Canada, Lagos Nigeria, Doha Qatar, Sao Paulo Brazil, Busan South Korea and Abu Dhabi UAE.

MSI is a niche Turnkey Contractor that functions as a single point of responsibility for the implementation of all pipe labeling, in-plant signage, valve tagging and equipment identification on major construction projects. The company currently employs over three hundred employees and operates in twelve countries.

Building Construction Management
Fall 2013

9.27.2013

Booth #29

<http://www.markserv.com>



McCarthy Building Companies, Inc. has been a community builder for nearly 150 years.

First and foremost, we're builders. Self-performance remains the foundation of our business. Couple this hands-on approach with a passionate belief in our people; a desire to build relationships based on trust and integrity; and a deeply-felt obligation to give back to our communities. Now, you begin to understand what lies at the heart of McCarthy—what truly sets us apart.

Clients turn to McCarthy to solve their toughest construction challenges, and our employees are inspired to step up and overcome these. We provide construction management, general contracting, design-build and self-perform service nationwide.

Building Construction Management
Fall 2013

9.27.2013

Booth #101

<http://www.mccarthy.com>



McShane Construction Company is a design/build construction firm headquartered in Rosemont, Illinois with offices in Auburn, Alabama, Phoenix, Arizona and Irvine, California. The firm was established in 1984 and has consistently ranked as one of ENR's Top 400 Contractors and Top 100 Design/Builders in the nation.

The firm specializes in providing design and construction services to the commercial market with specific concentration within the manufacturing, distribution, office, hospitality, multi-family, retail and institutional markets.

Building Construction Management
Fall 2013

9.27.2013

Booth #44

<http://www.mcshane-construction.com>



The Meade has been performing electrical construction and maintenance work in the greater Chicago metropolitan area for 100 years. The company is an Electrical Contractor as well as a registered Professional Design Firm. Meade routinely performs an extensive list of project capabilities for a varied customer base in the utility, heavy industrial, institutional, commercial and telecommunications sectors in Illinois, Indiana, and Wisconsin.

Meade and its employees are committed to safety, quality and value in the electrical construction industry that exceed its customers' expectations. Meade is committed to achieve that mission by creating an environment of mutual trust, respect and teamwork with dedication to continuous improvement.

Building Construction Management
Fall 2013

9.27.2013

Booth #40

<http://www.meade100.com>



Construction Advisory Council Member

Building Construction Management
Fall 2013

9.27.2013

Booth #4

Messer Construction Co. is a regional construction manager, general contractor and design-builder with an 81 year track record of proven success. Messer Construction is an employee owned company with offices in nine locations: Columbus, Cincinnati, and Dayton Ohio; Louisville and Lexington Kentucky; Indianapolis, Indiana; and Knoxville & Nashville, Tennessee, and Charlotte, North Carolina. We are a company of builders, with more than 700 construction leaders and innovators. Our long-term, sustainable success lies in the quality of our construction professionals. We believe in growth-from-within and invest in career planning & development to lead construction innovation within the industry.

<http://www.messer.com>



Construction Advisory Council Member

Building Construction Management
Fall 2013

9.27.2013

Booth #71

As one of the Midwest's leading construction firms, the foundation of Meyer Najem is our commitment to client satisfaction, employee satisfaction and the communities we serve. Through those commitments, our management-owned firm consistently delivers on promises and exceeds expectations. As a result, Meyer Najem is repeatedly selected for premiere projects in the healthcare, senior living, commercial, church/religious, government and institutional markets throughout the Midwest.

<http://www.meyer-najem.com>



Construction Advisory Council Member

Building Construction Management
Fall 2013

9.27.2013

Booth #68

Founded in 1919, Michuda Construction, Inc. is a family owned, full service General Contracting and Construction Management firm based on the south-side of Chicago. Michuda specializes in constructing and renovating facilities for health care, educational and commercial clients throughout the Midwest. By focusing our resources on select business sectors throughout the Midwest, Michuda Construction, Inc. is able to consistently deliver superior service tailored to our clients' needs while maintaining a healthy balance between life and work for our employees.

<http://www.michuda.com>



Building Construction Management
Fall 2013

9.27.2013

Booth #83

Founded in 1954, Mortenson Construction is a U.S.-based, privately-held construction company. As one of the nation's top builders, Mortenson provides a complete range of services, including planning, program management, preconstruction, general contracting, construction management, design-build, and development. Our foundation and culture are based upon our company values of trust, safety, teamwork, responsibility, service and stewardship. We are inspired by a compelling purpose to build structures and facilities for the advancement of modern society and a mission to create an exceptional customer experience. Mortenson has built a reputation for being a leader in our industry and in the communities in which we live and work.

<http://www.mortenson.com>



The National Demolition Association is a non-profit trade organization representing approximately 800 U.S. and Canadian companies and many international firms that are involved in the demolition process. Membership includes demolition contractors, general contractors, civil engineering firms, and recycling, landfill, and salvage operations. The association's efforts help members stay abreast of environmental, regulatory and safety matters, keep regulators informed about issues facing the industry, increase public and industry awareness, and provide members with networking opportunities and information on the latest technical advances in equipment and services.

Building Construction Management
Fall 2013

9.27.2013

Booth #75

<http://www.demolitionassociation.com>



Norcon, Inc. is a mid-sized general contractor located just west of the downtown "Loop" in Chicago, IL. Founded in 1999 by two young entrepreneurs from larger Chicago-based contractors, Norcon is a leader in providing top quality service for their clients. Their resume of projects is quite diverse including commercial, retail, educational, pharmaceutical as well as high-end residential. While some projects have taken Norcon to various parts of the country, the majority of work is in the downtown Chicago area or near suburbs. They manage all aspects of construction from the initial preconstruction phase through final completion.

Building Construction Management
Fall 2013

9.27.2013

Booth #98

<http://www.norconinc.com>



Founded in 1948, Ryan Homes has constructed more than 365,000 homes. Ryan Homes offers housing styles to suit a wide range of consumer needs, including single-family, townhouse or garden condominium.

Ryan Homes is a division of NVR homebuilding, which sells and constructs homes as Ryan Homes, NV Homes, Fox Ridge Homes and Heartland Homes. Operations serve over 25 metropolitan areas in more than fifteen states, including Maryland, Virginia, West Virginia, Pennsylvania, New York, New Jersey, Delaware, Indiana, Illinois, Ohio, North Carolina, South Carolina, Florida and Tennessee.

Building Construction Management
Fall 2013

9.27.2013

Booth #49

<http://www.nvrinc.com>



The Opus Group® is a family of national commercial real estate companies headquartered in Minneapolis, with expertise in development, project management, construction, architecture and engineering. Recognized as a national leader in office, industrial, retail, institutional, residential living and government projects, The Opus Group delivers the highest quality buildings.

Driven to create great buildings, The Opus Group listens to and collaborates with clients, finding excellent real estate opportunities, and making communities better places to live, work and raise families. Its team members bring combined decades of experience, building on a rich history started in 1953. Collectively, these companies have completed in excess of 2,600 projects totaling 264 million square feet.

Building Construction Management
Fall 2013

9.27.2013

Booth #46

<http://www.opus-group.com>



Panattoni Construction has grown into one of the recognized leaders in the construction industry, ranking among the nation's top contractors in such fields as design-build, industrial and manufacturing construction.

Panattoni Construction offers an array of construction services that are customized to fit the unique needs of each client. Our consistent team approach, from the early planning stages through construction, ensures that the client's needs and expectations shape the project schedule, design and delivery. With our project team focused on working together, our clients are assured a quality project, built in a safe work environment and delivered on time and within budget.

Building Construction Management
Fall 2013

9.27.2013

Booth #106

<http://www.panconinc.com>



CONSTRUCTION LEADERS

Construction Advisory Council Member

The PCL family of companies is a group of independent construction firms with an annual volume of more than \$6 billion. PCL is ranked the 6th Top US Contractor by ENR. Our areas of expertise are commercial buildings, transportation infrastructure, water infrastructure and industrial. With projects spanning the entire US, our district offices reside in California, Washington, Alaska, Hawaii, Arizona, Texas, Colorado, Minnesota, North Carolina, Georgia and Florida. PCL is 100% employee-owned with more than 108 years of construction excellence. Our commitment to professional development has allowed our employees to build their career with PCL and help us stand out as a leader in construction.

Building Construction Management
Fall 2013

9.27.2013

Booth #2

<http://www.pcl.com>



Panattoni Construction has over 25 years of experience building commercial projects for both public and private owners. We serve our clients throughout the country from 10 offices, which include Atlanta, GA; Chicago, IL; Dallas, TX; Denver, CO; Edison, NJ; Newport Beach, CA; Nashville, TN; Reno, NV; Seattle, WA and with Sacramento, CA being our corporate headquarters.

Panattoni Construction offers a diverse background of general contracting, construction management and design-build experience of industrial, commercial, healthcare, education, retail and government projects. In its 25 year history, Panattoni has achieved substantial revenue growth. Our client list is perhaps the greatest tribute to the professionalism and performance of the company. We are proud to perform work for owners with whom we have developed lasting relationships, deriving roughly 80% of our work from repeat clients. A privately-held company, Panattoni has worked on projects ranging from \$250,000 to \$80 million.

Visit: www.panconinc.com
Like Us: [facebook.com/PanattoniConstruction](https://www.facebook.com/PanattoniConstruction)



Construction Advisory Council Member

Building Construction Management
Fall 2013

9.27.2013

Booth #10

Pepper Construction Group (www.pepperconstruction.com) is a general contracting and construction management firm that primarily serves the non-residential and private sector markets. Since 1927, the company has served a full range of clients including: retail, education, health care, institutional, industrial, commercial, interiors, hotel, and entertainment markets. With 2012 gross revenues of \$1.02 billion, this Chicago-based privately owned company has more than 950 employees and major offices in Illinois, Indiana, Texas and Ohio.

<http://www.pepperconstruction.com>



Building Construction Management
Fall 2013

9.27.2013

Booth #11

Pepper Construction Company of Indiana (www.pepperconstruction.com/Indiana) is a general contracting and construction management firm that primarily serves the non-residential and private sector markets. As part of Pepper Construction Group, established in 1927, the company has served a full range of clients including: retail, education, health care, institutional, industrial, commercial, interiors, hotel, and entertainment markets. The company had a gross revenue of \$1.02 billion in 2012, is a privately owned company with more than 950 employees and major offices in Illinois, Indiana, Texas and Ohio.

<http://www.pepperconstruction.com/indiana>



Building Construction Management
Fall 2013

9.27.2013

Booth #102

Performance Contracting Group (PCG) is one of the leading specialty contractors in the United States. Our family of companies provides a wide range of quality services and products to the industrial, commercial, and non-residential markets.

PCG was formed in February 1987 when it was purchased from Owens Corning Fiberglass by several existing employees in the 40-year-old division. Since then, PCG's reputation for "providing value that exceeds customers' expectations" has warranted our significant growth. PCG is employee-owned and now has 50+ offices throughout the United States.

PCG is the parent company of Performance Contracting, Inc (PCI). PCI is our largest subsidiary and has two main divisions, Interior Services, and Insulation & Specialty Services. This allows us to offer our customers diverse but related services, making PCI a true "single-source" contractor for many customers.

We are proud to say that our selective hiring process and active recruiting methods have produced an incredible team of overachievers. We now employ more than 800 salaried individuals and 6,000 skilled craft workers across the U.S.

<http://www.pcg.com>



Building Construction Management
Fall 2013

9.27.2013

Booth #26

Performance is a Heavy Industrial and Mechanical Contractor that services the Petroleum Refinery, Chemical, Petro-Chemical, Pulp-paper, and power industries.

In Business for 33 years as a general contractor. Please visit our website for more information at www.Performance-br.com

<http://www.performance-br.com>



Construction Advisory Council Member

Power Construction is an 87 year-old management-owned company that has worked primarily in the Chicago area since 1926. Among the firms doing so, we are the largest. We are able to deliver a higher level of service by concentrating on five customer markets; Corporate, Developer, Healthcare, Hotel, and Education. We believe construction is much more than just a business of bricks and mortar; it is a business of people and service. As such, our company's organizational depth and stability are essential to success. Today, more than 90% of our work is awarded by repeat customers. This record for repeated selection demonstrates our firm's reputation for performance and customer satisfaction.

Building Construction Management
Fall 2013

9.27.2013

Booth #5

<http://www.powerconstruction.net>



We Don't Just Offer Jobs. We Build Careers.

Join the Power Design team, and you'll get more than a job. You'll discover countless opportunities to build the career you've always wanted. Recognized by Tampa Bay Business Journal as a "Best Place to Work" (one of the top three in 2009 and a finalist in 2012) and by the Associated Builders and Contractors organization as an "Accredited Quality Contractor," we know our success as a company is measured by the individual achievements of our team members. That's why we invest the time and resources to help every team member succeed. With personalized career coaching, technical skills development and management training programs, you'll find a career path that's right for you at Power Design.

Building Construction Management
Fall 2013

9.27.2013

Booth #105

<http://www.powerdesigninc.us>



ProCLAD is a high-value provider of architectural building exteriors. Our knowledgeable, dedicated associates work professionally with an exclusive group of vendors and customers in an environment built on commitment and trust. □□ As a construction company focused on the building's exterior envelope, we provide a unique opportunity for businesses and organizations to enhance the image and client perception by improving the appearance of a fundamental aspect of every business- the building itself.

Building Construction Management
Fall 2013

9.27.2013

Booth #28

<http://www.procladinc.com>



PulteGroup has been providing the American Dream of homeownership to families for 60 years. What started as a single home built and sold by the entrepreneurial spirit of an 18-year-old Bill Pulte, has grown into the industry's sole multi-brand homebuilding company with the ability to serve customers in all phases of life. Today, PulteGroup operates in approximately 60 markets throughout the country.

Building Construction Management
Fall 2013

9.27.2013

Booth #85

<http://www.pulte.com>



The Project Management and Construction (PM&C) department of Purdue University's Physical Facilities organization is looking for summer interns to contribute to and learn from campus development and construction. In PM&C, we provide the wide range of professional services that are necessary to coordinate, manage, and complete construction projects on Purdue's West Lafayette campus, with oversight of these activities at regional campuses. Performing in-house and capital project management, and project controls functions, we are responsible for facilitating construction and development on behalf of the Purdue community. We offer prospective interns a fast-paced, professional learning environment from the planning table to the job site.

Building Construction Management
Fall 2013

9.27.2013

Booth #110

http://www.purdue.edu/architect/project_mgmt/index.htm



Integrity drives everything we do at Rieth-Riley and every employee knows the importance of quality performance. Rieth-Riley is a heavy/highway and commercial construction company with offices located in Indiana and Michigan. Founded in 1916, we have evolved into a unique and respected company in the industry. Rieth-Riley is a principal contractor for work in site development, bridges, concrete structures, airport paving, test and race track paving, street and subdivision paving, and for producing bituminous and portland cement as well as concrete mixes. We are a 100% employee owned (ESOP) company.

Building Construction Management
Fall 2013

9.27.2013

Booth #20

<http://www.rieth-riley.com>



RK Mechanical is the largest mechanical contractor in the region. We encourage an environment of innovation and opportunity. Work alongside the most skilled tradesman in the industry. We invest in our employees with competitive compensation, ongoing training, and personal development. Our commitment to safety is unbending. RK mechanical conducts regular team building events to encourage camaraderie and collaboration. We offer competitive benefit package including health, vision, dental, and 401K investment. Our "RK Wellness program" provides employees with resources and incentives to live a healthy lifestyle.

Building Construction Management
Fall 2013

9.27.2013

Booth #16

<http://www.rkmi.com>



Ryan Fireprotection, Inc. is a leading fire protection contractor located in Noblesville, IN. Our mission is to provide state-of-the-art fire protection systems to preserve lives and property in the communities we serve.

Building Construction Management
Fall 2013

9.27.2013

Booth #99

<http://www.ryanfp.com>



Ryland Homes is the United States' 7th-largest developer and new home-builder. The builder, based in Westlake Village, California, has built over 300,000 homes across the United States since its inception, focusing primarily on first-time homebuyers and first- and second-time moveup buyers. Ryland currently builds in 14 states and the District of Columbia.

In addition to its homebuilding segment, Ryland's other business unit is RMC Mortgage Corp. which specializes in financial services such as consumer mortgages, homeowner's insurance, title, and escrow services.

Building Construction Management
Fall 2013

9.27.2013

Booth #25

<http://ryland.com>



Construction Advisory Council Member

Building Construction Management
Fall 2013

9.27.2013

Booth #8

A Track Record of Leadership & Success: Satterfield & Pontikes Construction, Inc., has used a customer-centric approach to business & cutting-edge technology to become one of the leading, award winning construction companies in the Gulf Coast region. Led by President & CEO George A. Pontikes Jr., S&P has offices in Texas & Louisiana. S&P has successfully completed more than 500 projects, from new theaters to renovations of New Orleans schools ravaged by Hurricane Katrina.

Helping the Customer see Results: S&P specializes in General Contracting, Construction Manager-at-Risk & Design-Build delivery methods. Our clients vary across a wide spectrum: educational, institutional, commercial, entertainment, manufacturing, retail, disaster relief, airport, health care, & facilities management....

<http://www.satpon.com>



Saunders Construction is one of the most respected commercial builders in the Rocky Mountain region. Saunders is recognized for commitment and focus that help turn ideas into projects and projects into landmarks. The culture Dick Saunders established in 1972 is one of personal integrity and open communication, and the organization continues to embody that spirit at every level. We honor all commitments. We meet tough deadlines. Our ability to consistently meet or exceed the goals of the project team creates a responsive client relationship—building confidence one job at a time.

Building Construction Management
Fall 2013

9.27.2013

Booth #92

<http://www.saundersci.com>



Schindler Elevator Corporation designs, manufactures, installs, services and modernizes a broad range of elevators, escalators and moving walks for almost every building type. The company is the North American operation of the Swiss-based Schindler Group, a leading global mobility provider with approximately 45,000 employees operating in more than 100 countries. Supporting sustainable urban development with safe, reliable and ecologically sound mobile solutions, Schindler equipment moves one billion people everyday all over the world.

Building Construction Management
Fall 2013

9.27.2013

Booth #47

<http://www.schindler.com/us/internet/en/home.html>



Join us. Move further.

Schindler moves more than 1 billion people a day around the world — with elevators, escalators and innovative mobility solutions. Nearly 45,000 employees in over 100 countries on all continents are behind this success.

If you are ready to be challenged, to be exposed to different cultures, have the desire for growth and want to work for a global leader, visit the Careers section of our website.

Schindler Elevator Corporation
www.us.schindler.com

*An equal opportunity employer.
Committed to workforce diversity.*



Schindler



Signature Construction has been in business for over 30 years and is a leading Construction Management Company in building multi-family apartment homes.

Building Construction Management
Fall 2013

9.27.2013

Booth #88

<http://www.pedcorcompanies.com>

SKANSKA

Skanska USA is one of the largest, most financially sound construction and development networks in the country, serving a broad range of industries including healthcare, education, sports, data centers, government, aviation, transportation, power, energy, water/wastewater and commercial. Headquartered in New York with 39 offices across the country, Skanska USA employs more than 8,300 employees committed to sustainable construction and development and an injury-free workplace.

Construction Advisory Council Member

Building Construction Management
Fall 2013

9.27.2013

Booth #57

<http://usa.skanska.com>



STARCON is an Illinois based company founded in 1983. We are a full service mechanical contractor, specializing in servicing the Petrochemical Industry. The foundation of our company lies in our uncompromising commitment to Safety, Quality, Training, and Innovation. STARCON's craftspeople are enthusiastic, highly-trained, turnaround, scaffolding, piping and specialty welding.

Construction Advisory Council Member

Building Construction Management
Fall 2013

9.27.2013

Booth #69

<http://www.starconinternational.com>



Suffolk Construction:

In just 30 years, Suffolk Construction has become of the most successful privately-held building construction contractors in the industry. Our experienced and skilled employees, proactive approach to managing projects, strategic focus and financial strength truly differentiate us from other construction management firms. Suffolk's Core Values- passion, integrity, hard work, and professionalism – best describe who we are as a company and the characteristics each of our employees bring to our organization.

Building Construction Management
Fall 2013

9.27.2013

Booth #36

Our unprecedented success has a surprisingly simple explanation – our consistently high performance and strong commitment to client services has built a strong reputation that has attracted and retained clients from every industry sector and region...

<http://www.suffolk.com>



Originally founded in 1908, The Hagerman Group (THG) has come to represent the gold standard in providing construction solutions. THG is well suited to perform in a variety of building delivery methods, including construction management, general contracting, and design-build. THG also has the ability to self-perform concrete, masonry, carpentry, and other general trades. We complete projects of all sizes and in a variety of vertical markets, including education, healthcare, institutional, energy, industrial, and commercial/retail. Additionally, THG is an industry leader in the green building market and is one of the leading employers of LEED accredited professionals in the state of Indiana. The Hagerman Group: an innovative construction solution provider for over 100 years!

Building Construction Management
Fall 2013

9.27.2013

Booth #37

<http://www.thehagermangroup.com>



The Hill Group is one of the nation's largest, most comprehensive mechanical design, construction, service, operations and facilities management companies. Founded in 1936, the company employs over 800 professionals through its Franklin Park, Illinois office.

At Hill our team members strive to be the best in the industry. We encourage innovation and contribution among all our team members which offers endless opportunities to learn and grow. The Hill Group's entrepreneurial philosophy allows for advancement and mentoring opportunities.

The Hill Group is a family-friendly work environment with several members serving for several decades. In 2008, Hill was named Top Workplace by Crain's Chicago Business and again in 2010 by the Chicago Tribune's Top Chicago Workplaces.

Building Construction Management
Fall 2013

9.27.2013

Booth #78

<http://www.hillgrp.com/>



STARCON INTERNATIONAL

A LEADER IN THE PETROCHEMICAL INDUSTRY, a full service mechanical contractor providing plant construction and turnaround execution is currently seeking experienced Team Members for current and upcoming work.

Northern Hub
260 Market Place
Manhattan IL 60442

Western Hub
4833 Auto Plaza Ct
Fairfield CA 94534

Southern Hub
1723 Center St
Deer Park TX 77536

Tri-State Hub
2181 Rt 60
East Culloden WV 25510

Louisiana Hub
26505 Oak Plaza Ste A
Prairieville LA 70769

THE HILL GROUP

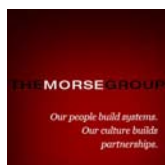

Building Construction Management
Fall 2013

9.27.2013

Booth #34

The Morse Group originated with the founding of Morse Electric, Inc. in 1944. Since its inception, Morse Electric has continued to grow and is an industry leader ranking among the top 50 electrical contracting firms in the United States, with permanent offices in multiple states and project operations nationwide. The Morse Group has expanded operations to include focused specialty companies anchored in the electrical, energy and construction markets. The Morse Group is now comprised of a strong network of member companies with over \$150 million in annual sales. Collectively, these member companies bring specialty engineering, construction, automation services and project management under a unified umbrella to provide convenience and value for our customers.

<http://www.themorsegroup.com>



Building Construction Management
Fall 2013

9.27.2013

Booth #97

The Ross Group provides services in Design-Build, General Contracting, Construction Management and Facilities Maintenance. TRG offers effective management for today's building requirements with regard to cost, quality, safety and environmentally responsible methods of construction. 3+ years and counting without a loss time accident and 3 LEED Gold and 1 Silver Certifications with pending status on 4 more LEED projects. Our focus on Government/Military installations along with our growing commercial business has assured us of stability and growth in the market.

<http://www.trgcc.com>



Construction Advisory Council Member

Building Construction Management
Fall 2013

9.27.2013

Booth #74

The Skillman Corporation is a family owned CM firm founded in 1972 with offices in IN, MI & OH. Our services include construction & program management, design/build, estimating & feasibility studies for colleges, universities, municipalities, senior living, healthcare, K-12 public & private education, hotel & casinos projects. Our employees are our No. 1 asset we encourage continuing education, professional development, and participation in local community & lead the industry with innovative technology & web based management tools. As members of the Metro Indianapolis Coalition for Construction Safety, Safety is First. The Skillman Corporation may be best described as the biggest little construction management firm in the Midwest ranked 90th largest Construction Management firm by EN...

<http://www.skillman.com>



Construction Advisory Council Member

Building Construction Management
Fall 2013

9.27.2013

Booth #1

The Walsh Group, founded in 1898, is a family owned and operated company. As one of the nation's largest contractors, The Walsh Group provides construction management, design-build and self-performed services through the operations of three subsidiaries: Walsh Construction, Archer Western Contractors, and R&L Brosamer. Major attributes to The Walsh Group's success is their commitment to the highest standards for quality and safety. The Walsh Group regularly employs over 5,000 engineers, managers, and skilled trades' workers and boasts one of the nation's largest equipment fleets. Walsh strives to be the employer of choice for employees and the builder of choice for customers.

<http://www.walshgroup.com>



Building Construction Management
Fall 2013

9.27.2013

Booth #77

Thieneman Construction, Inc. is an award winning Heavy Civil General Contractor specializing in the water and wastewater industries. Operating out of Merrillville, and Westfield, IN, Thieneman Construction, Inc. has successfully built projects throughout the States of Indiana, Illinois, and West Virginia.

Currently our projects' contract values range in size of \$100,000 to \$14,000,000; of which, Thieneman Construction typically self performs 85%. Company performed activities include earthwork, concrete, mechanical installation and pipe installation.

Thieneman Construction, Inc. is a growing company in a fast pace environment. Thieneman Construction, Inc. is striving to be an employee owned company that has a philosophy of building future key team members from within.

<http://www.thienemanconstruction.com>



Building Construction Management
Fall 2013

9.27.2013

Booth #18

Thompson Thrift Construction is a nationally respected and recognized, full-service construction management company dedicated to serving individuals and businesses throughout Indiana, the Midwest and the United States. A reputation for service, quality and trust has accompanied its success, as has a record of delivering superior projects on time and on budget. During its 27 years of existence, Thompson Thrift's projects have included: multifamily, senior living, student housing, healthcare, historic renovation, retail, warehouses, commercial, restaurants, professional/office and industrial. The company is privately owned and employs 160 people. It has offices in Terre Haute, Houston and Indianapolis.

<http://www.thompsonthrift.com>



"BEING ABLE TO WORK WITH THE TECHNOLOGY WALSH HAS TO OFFER HAS OPENED MY EYES TO THE FUTURE OF BOTH THE INDUSTRY AND WALSH AS A COMPANY."

Eric, Heavy Civil Intern

THE WALSH GROUP



WE OFFER ENTRY-LEVEL AND INTERNSHIP/CO-OP OPPORTUNITIES.

PLEASE VISIT OUR WEBSITE FOR MORE DETAILS. AN EQUAL OPPORTUNITY EMPLOYER.

929 WEST ADAMS STREET | CHICAGO, ILLINOIS 60607 | P.312.563.5400

WWW.WALSHGROUP.COM



Tishman is one of the country's largest and most respected builders. We provide a wide range of clients with full-service construction solutions and manage billions of dollars of at risk work around the world. With over 110 years of experience in the construction industry, Tishman is responsible for the construction of more than 500 million square feet of space incorporating facilities of every size and type: office, hotel, entertainment, residential, retail, medical, educational, transportation, recreational and institutional.

Building Construction Management
Fall 2013

9.27.2013

Booth #103

<http://tishmanconstruction.com>



One of Chicago's Premier Commercial Electrical Contractors, Titan Electric is a distinguished contractor providing electrical, low voltage, fire alarm, fiber and design build services throughout the Chicagoland metropolitan area. We provide electrical and communication services including design, installation, testing, long-term service and maintenance on a wide array of projects. For more information, visit www.titan-elec.com or contact Jamie Juliano, Marketing Coordinator, at jjuliano@titan-elec.com.

Building Construction Management
Fall 2013

9.27.2013

Booth #15

<http://www.titan-elec.com>

A graphic advertisement for Tishman, an AECOM company. It features a blue sky background with a black silhouette of a city skyline. A large, stylized red 'T' is superimposed over the skyline. The text 'Proudly Building Chicago for Over 40 Years!' is at the top in red. Below it, in red, is 'For over 40 years, we have provided our Chicago clients with full-service construction solutions including:'. This is followed by a list of services in red: 'Construction Management', 'General contracting', 'Program management', and 'Design-build'. At the bottom, the word 'TISHMAN' is written in large white letters, with 'An AECOM Company' in smaller white letters below it.

Proudly Building Chicago for Over 40 Years!

For over 40 years, we have provided our Chicago clients with full-service construction solutions including:

- Construction Management
- General contracting
- Program management
- Design-build

TISHMAN
An AECOM Company



Traylor Bros., Inc. is one of the nation's leading heavy civil contractors. We have a staff of dedicated professionals employing some of the most innovative construction techniques in the industry to build landmark bridges, tunnels, and marine structures. We have chosen to focus our services on work that challenges our talented staff and puts to best use our vast array of specialty construction equipment. The result is a portfolio of projects that reflect the innovation and quality execution on which Traylor Bros. has built our stellar reputation. We are interested in Fall and Spring graduates for full time positions and also Co-op and Interns that would be willing to work during the Fall and Spring semesters. Our projects are spread all over the US. Please visit www.traylor.com

Building Construction Management
Fall 2013

9.27.2013

Booth #52

<http://www.traylor.com>



Turner Construction is recognized as the leading general builder in the United States, providing a complete range of construction and program management services. Turner builds buildings, but what truly sets us apart is how we build relationships, deliver brain-power, know-how, expertise and 100 years of experience to our clients. With a nationwide network of offices, Turner strives to maintain an environment where everyone has the opportunity to reach their potential. Hard work, dedication and integrity are the trademarks of Turner's staff. Turner is looking for talented full-time and intern Field Engineers. Equal Opportunity Employer

Construction Advisory Council Member

Building Construction Management
Fall 2013

9.27.2013

Booth #65

<http://turnerconstruction.com>

The advertisement features a large, bold, white, sans-serif word "EXCELLENCE" at the top. Below it is a photograph of a construction site showing a large, black, cylindrical structure being worked on by several workers in safety gear. A red crane is visible in the background. The Traylor Bros., Inc. logo is centered over the photograph. At the bottom, there is a QR code and a block of text.

EXCELLENCE

TRAYLOR
TRAYLOR BROS., INC.

Traylor Bros., Inc. knows that our people are our most important asset. Whatever we're building—a landmark bridge in New York, a light rail tunnel in Los Angeles, a floodwall in Louisiana—the top-notch quality of our projects is the direct result of the talent, effort, and commitment of our team.

For more information or to discover career opportunities, please visit www.Traylor.com

Pictured: Our New Barge-Mounted 4600 Ringer. Scan the QR Code for photos and details.

Turner

Opportunity Begins Here



TURNER CONSTRUCTION COMPANY

*Where Talented People Accomplish
Extraordinary Results*

Building Construction Management Fall Career Fair

September 27, 2013

10:00 am to 3:00 pm

Mackey Arena Concourse

For more information, please contact:

Turner Construction Company

c/o Human Resources

55 East Monroe Street, Suite 3100

Chicago, IL 60603

T: 312.327.2770

www.turnerconstruction.com

Turner is an Equal Opportunity Employer (M/F/D/V)

Ready to Build Your Future?



Building Construction Management
Fall 2013

9.27.2013

Booth #33

USA Fire Protection is the leading fire protection contractor in the Midwest. Founded in 1986 we continue to deliver a quality product by employing a team of dedicated and intelligent individuals striving toward excellence. We specialize in all types of fire protection, from special hazard projects to large high rise buildings. We are looking for energetic graduates who want a wide range of challenging opportunities in fire protection industry. Fire Protection layout, project management, building coordination, and overseeing field variables are all part of the fire protection design team responsibilities. If you are looking for a premier construction company with plenty of opportunity to succeed, please contact us.

<http://www.usafireprotectioninc.com>



Building Construction Management
Fall 2013

9.27.2013

Booth #45

A family owned specialty contractor for 72 years we have catered to a variety of markets including institutional and industrial, serving a diverse client base of commercial, manufacturing, governmental, and municipalities. Capable of undertaking an array of projects both large and small, in a prime capacity, makes Voris Mechanical Inc. a multifaceted organization.

<http://www.vorismechanical.com>



Building Construction Management
Fall 2013

9.27.2013

Booth #13

Weis Builders, established in 1939, has maintained a reputation for building solid relationships. As a third-generation, family-owned general contractor, we continue to exceed client's expectations with our versatility, responsiveness, talented associates, and progressive attitude. Weis Builders is ranked among the top US construction companies by Engineering News Record. We complete projects throughout the country from office locations in Minneapolis and Rochester, MN; Chicago, IL; and Dallas, TX. Weis Builders excels in various markets, including multi-unit residential, senior living, hospitality, retail, commercial, and healthcare. We support the development needs of our clients by providing delivery methods such as general contracting, design/build, and construction manageme...

<http://www.weisbuilders.com>



Building Construction Management
Fall 2013

9.27.2013

Booth #48

Western Utility Contractors provides construction and installation of telecommunication and other utilities in major cities, suburban municipalities and rural communities.

Telecom Division

- Wired and wireless
- Aerial and underground cable systems
- Long and short haul fiber systems
- Build, rebuild and upgrade
- Duct package installation

<http://www.westernutility.com>

Above & Beyond

University Park, IL-Champaign, IL-Fort Myers, FL

WESTERN UTILITY CONTRACTORS

BUILDING FOR THE FUTURE... TODAY

Telecommunications Electrical Hydroexcavation Directional Boring



www.westernutility.com

2565 Palmer Ave University Park, Illinois 60484

P 7 0 8 - 2 3 5 - 1 4 0 8 F 7 0 8 - 2 3 5 - 1 4 1 0



White Construction, Inc. (WCI) is a Heavy/Civil, Petro/Chemical and Alternative Energies contractor with corporate offices located in Indiana. WCI is engaged in a variety of challenging projects throughout North America. Committed to growth, WCI provides increasing opportunities for educated, aggressive professionals seeking challenging careers with the potential for accelerated advancement. Committed to a diverse workforce, WCI is an Equal Opportunity Employer.

Building Construction Management
Fall 2013

9.27.2013

Booth #27

<http://www.whiteconstruction.com>

The Department of Building Construction Management sincerely thanks all of the Fall 2013 companies and their representatives for their participation.

Special thanks to the Purdue Center for Career Opportunities, Purdue Conferences and all the student volunteers, faculty and staff who help host this event.

The Spring 2014 BCM Career Fair will be in the Purdue Memorial Union Ballrooms on Friday, February 14, 2014.

We hope to see you back on campus!

